



Fuse Holders

Bulgin's **extensive range** of fuse holders are **designed** to give the degree of **protection** demanded in today's sophisticated electronic equipment. Carrying world-wide safety approvals from **UL**, **VDE**, **CSA** and **IMQ**, all types are manufactured from high grade flame retardant **nylon** and **polyester** materials.

Designed primarily for 5 x 20mm and 6.3 x 32mm size fuses with protection against shock to categories PC1, PC2 and PC3. There's a choice of styles for Inline, PCB mounting and panel mounting (screw or snap fit) with terminal options for solder, 2.8mm, 4.8mm or 6.3mm tabs or PC spills. Dust and waterproof designs provide a front of panel seal to IP68 in both 5 x 20mm and 6.3 x 32mm size fuses.

Fuse carrier styles include captive drawer, screw cap - with screw driver release, bayonet cap - with screw driver release and screw cap - with finger release.

| | |
|--|----|
| Panel/PC Mounting Captive Carriers Touchproof, PC3 | 4 |
| Panel Mounting Touchproof, Sealed to IP68, PC2 | 11 |
| Panel Mounting Touchproof, Sealed to IP66, PC1 | 12 |
| PC Mounting PC1, PC2 and PC3 | 13 |
| Base Mounting, PC1 | 15 |
| Inline PC1 and Inline Sealed to IP66, PC1 | 16 |

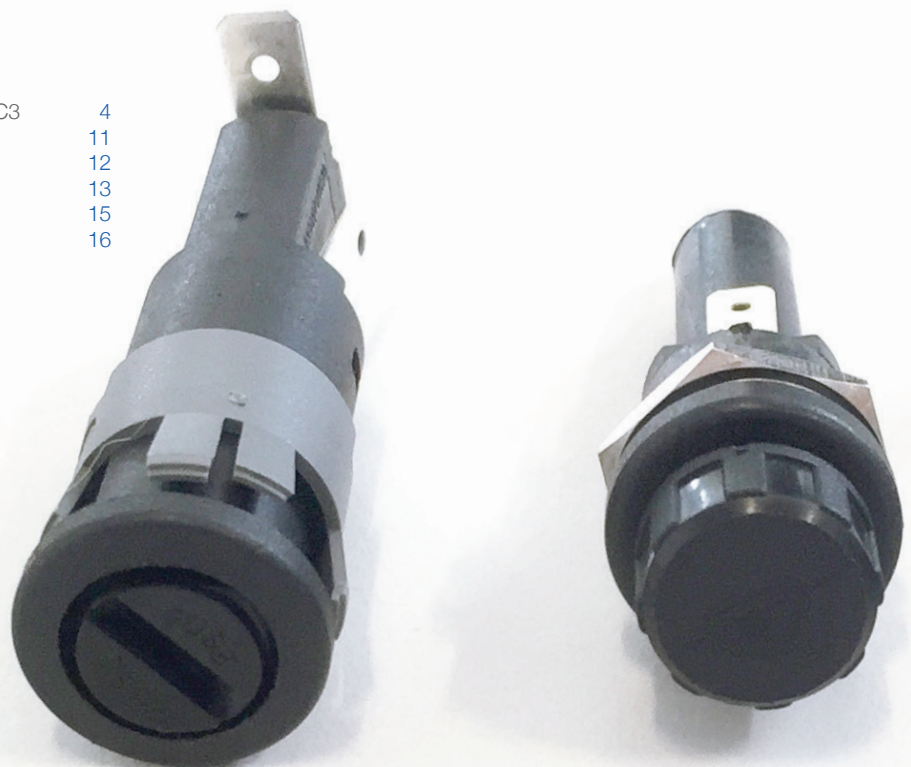

Category PC1:

No integral protection against electric shock. If required, Designers/Manufacturers must provide additional protection against electric shock on equipment.

Category PC2:

With integral protection against electric shock. Fuseholders shall have live parts inaccessible to IEC 60529 Standard Test Finger, when fully assembled, without fuse carrier or fuse in place and when fuse carrier, with fuse is being inserted or withdrawn.

Category PC3:

With integral protection against electric shock. Fuseholders shall have live parts inaccessible to IEC 60529 1mm dia. rigid test wire when fully assembled, without fuse carrier or fuse in place and when fuse carrier, with fuse, is being inserted or withdrawn.

Snap Fit to Panel



FX0430/63

- Protection Category PC3
- Fuse Size 5 x 20mm
- Panel Thickness 1.0, 1.5, 2.0 & 3.0mm
- Captive Drawer
- 10A, 250V (16A, 250V UL)
- 2.8, 4.8 or 6.3 tabs

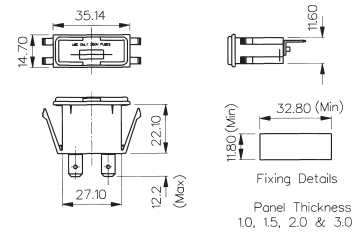



Snap Fit to Panel

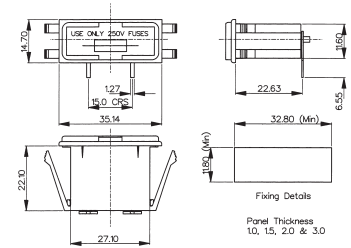

FX0430/PC

- Protection Category PC3
- Fuse Size 5 x 20mm
- Panel Thickness 1.0, 1.5, 2.0 & 3.0mm
- Captive Drawer
- 10A, 250V (16A, 250V UL)
- PC spills



| Specifications | FX0430/Termination | FX0430/PC |
|-------------------------|---|---|
| Fuse Size: | 5 x 20mm | 5 x 20mm |
| Fuse Carrier: | Captive Drawer | Captive Drawer |
| Terminations: | /28 (2.8mm solder), /48 (4.8mm tab), /63 (6.3mm tab) | /PC (PC spills) |
| Max. Rating: | 10A, 250V (16A, 250V AC UL) | 10A, 250V (16A, 250V AC UL) |
| Max. Power Dissipation: | 2.5W (@ 23°C) | 2.5W (@ 23°C) |
| Insulation Resistance: | >10MΩ @ 500V DC | >10MΩ @ 500V DC |
| AC Breakdown: | >2kV | >2kV |
| Contact Resistance: | <10mΩ | <10mΩ |
| Operating Temp: | -20°C to +85°C (ambient air temp + fuse temp rise) | -20°C to +85°C (ambient air temp + fuse temp rise) |
| Mouldings: | | |
| Body/Drawer: | Nylon UL94V-0 rated | Nylon UL94V-0 rated |
| Cap: | | |
| Nut: | | |
| Contacts: | Contact tags: Brass, Tin Plated Fuse Clips: Phosphor Bronze, Nickel Plated | Contact tags: Brass, Tin Plated Fuse Clips: Phosphor Bronze, Nickel Plated |
| Approvals: |  | |
| Accessories: | | |
| Note: | | |
| RoHS | Compliant | Compliant |

Panel Mount



FX0357

FX0359

- Protection Category PC2
- Fuse Size 5 x 20mm
- Bayonet Cap/Screwdriver Release
- 10A, 250V (16A, 250V UL)

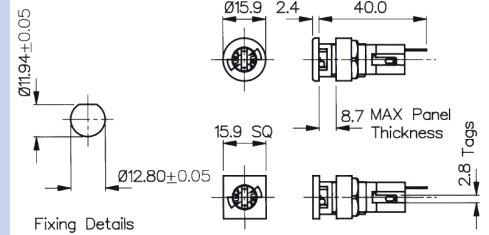

Snap Fit to Panel





FX0367

FX0369

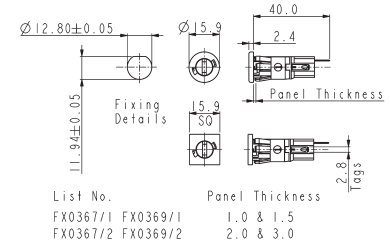
- Protection Category PC2
- Fuse Size 5 x 20mm
- Panel Thickness 1.0 & 1.5 and 2.0 & 3.0mm
- Bayonet Cap/Screwdriver Release
- 10A, 250V (16A, 250V UL)



| Specifications | FX0357, FX0359 | FX0367/Panel, FX0369/Panel |
|-------------------------|---|---|
| Fuse Size: | 5 x 20mm | 5 x 20mm |
| Panel Thickness: | | /1 (1.0-1.5mm panel, black sleeve) /2 (2.0-3.0mm panel, grey sleeve) |
| Fuse Carrier: | Bayonet cap/Screwdriver release | Bayonet cap/Screwdriver release |
| Terminations: | Solder tags | Solder tags |
| Max. Rating: | 10A, 250V (16A, 250V AC UL) | 10A, 250V (16A, 250V AC UL) |
| Max. Power Dissipation: | 2.5W (@ 23°C) | 2.5W (@ 23°C) |
| Insulation Resistance: | >10 ² MΩ @ 500V DC | >10 ² MΩ @ 500V DC |
| AC Breakdown: | 7kV @ 50Hz | 7kV @ 50Hz |
| Contact Resistance: | <10mΩ | <10mΩ |
| Operating Temp: | -20°C to +85°C (ambient air temp + fuse temp rise) | -20°C to +85°C (ambient air temp + fuse temp rise) |
| Mouldings: | | |
| Body: | Polyester UL94V-0 rated | Polyester UL94V-0 rated |
| Cap: | Nylon UL94V-0 rated | Nylon UL94V-0 rated |
| Nut: | Glass Filled Nylon UL94V-0 rated | |
| Contacts: | Brass, Silver Plated | Brass, Silver Plated |
| Approvals: |  |  |
| Accessories: | P.No. 11327 (See page 17) | P.No. 11327 (See page 17) |
| RoHS | Compliant | Compliant |

Panel Mount



FX0454, FX0455

- Protection Category PC2
- Fuse Size 5 x 20mm
- Screw Cap/Screwdriver Release
- Keyway Panel Cutout (FX0454)
- D Panel Cutout (FX0455)
- 10A, 250V (16A, 250V UL)

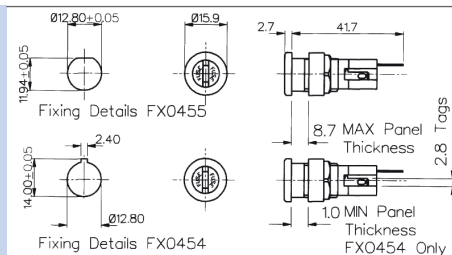

Panel Mount



FX0454/S, FX0455/S

- Protection Category PC2
- Fuse Size 5 x 20mm
- Screw Cap/Screwdriver Release
- High Profile Bezel
- Keyway Panel Cutout (FX0454/S)
- D Panel Cutout (FX0455/S)
- 10A, 250V (16A, 250V UL)

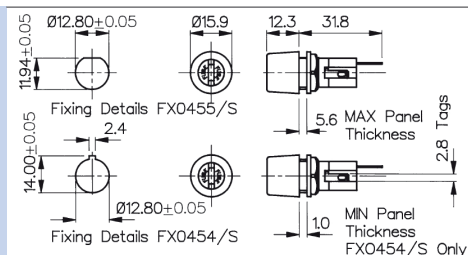

Snap Fit to Panel



FX0458

- Protection Category PC2
- Fuse Size 5 x 20mm
- Panel Sizes 1.0 & 1.5 and 2.0 & 3.0mm
- Screw Cap/Screwdriver Release
- 10A, 250V (16A, 250V UL)

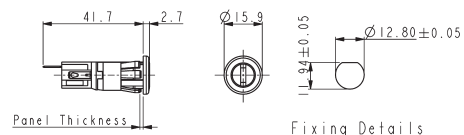

| List No. | Panel Thickness |
|----------|-----------------|
| FX0458/1 | 1.0 & 1.5 |
| FX0458/2 | 2.0 & 3.0 |

| Specifications | FX0454, FX0455 | FX0454/S, FX0455/S | FX0458 |
|-------------------------|---|---|---|
| Fuse Size: | 5 x 20mm | 5 x 20mm | 5 x 20mm |
| Panel Size: | | | /1 (1.0-1.5mm panel, black sleeve) /2 (2.0-3.0mm panel, grey sleeve) |
| Fuse Carrier: | Screw cap/Screwdriver release | Screw cap/Screwdriver release | Screw cap/Screwdriver release |
| Terminations: | Solder tags | Solder tags | Solder tags |
| Max. Rating: | 10A, 250V (16A, 250V a.c. UL) | 10A, 250V (16A, 250V AC UL) | 10A, 250V (16A, 250V AC UL) |
| Max. Power Dissipation: | 2.5W (@ 23°C) | 2.5W (@ 23°C) | 2.5W (@ 23°C) |
| Insulation Resistance: | >10 ¹² MΩ @ 500V d.c. | >10 ¹² MΩ @ 500V DC | >10 ¹² MΩ @ 500V DC |
| A.C. Breakdown: | 7kV @ 50Hz | 7kV @ 50Hz | 7kV @ 50Hz |
| Contact Resistance: | <10mΩ | <10mΩ | <10mΩ |
| Operating Temp: | -20°C to +85°C (ambient air temp + fuse temp rise) | -20°C to +85°C (ambient air temp + fuse temp rise) | -20°C to +85°C (ambient air temp + fuse temp rise) |
| Mouldings: | | | |
| Body: | Polyester UL94V-0 rated | Polyester UL94V-0 rated | Polyester UL94V-0 rated |
| Cap: | Nylon UL94V-0 rated | Nylon UL94V-0 rated | Nylon UL94V-0 rated |
| Nut: | Glass Filled Nylon UL94V-0 rated | Glass Filled Nylon UL94V-0 rated | |
| Contacts: | Brass, Silver Plated | Brass, Silver Plated | Brass, Silver Plated |
| Approvals: |  |  |  |
| Accessories: | P.Nos. 11327, 12297 & 12298 (See page 17) | P.Nos. 11327, 12297 & 12298 (See page 17) | P.Nos. 11327 (See page 17) |
| RoHS | Compliant | Compliant | Compliant |

Panel Mount



FX0415, FX0416

- Protection Category PC2
- Fuse Sizes:
 - 6.3 x 32mm (FX0415)
 - 6.3 x 25mm (FX0416)
- Screw Cap/Hand Release
- 13A, 250V (16A, 250V UL)



5.5 MAX
1.0 MIN
Panel
Ø19.1
11.5
54.4 MAX
Key Pos'n
(With Fuse Fitted)
Ø16.0
17.27
2.54
Fixing Detail

Panel Mount



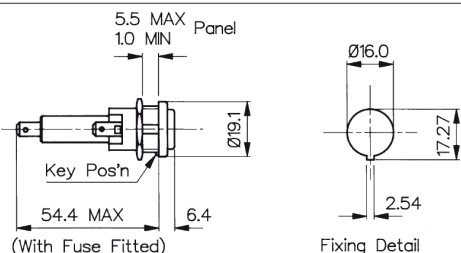

FX0415/S, FX0416/S

- Protection Category PC2
- Fuse Sizes:
 - 6.3 x 32mm (FX0415/S)
 - 6.3 x 25mm (FX0416/S)
- Screw Cap/Screwdriver Release
- 13A, 250V (16A, 250V UL)



5.5 MAX
1.0 MIN
Panel
Ø19.1
6.4
54.4 MAX
Key Pos'n
(With Fuse Fitted)
Ø16.0
17.27
2.54
Fixing Detail

| Specifications | FX0415, FX0416 | FX0415/S, FX0416/S |
|--|---|---|
| Fuse Size: | FX0415 - 6.3 x 32mm FX0416 - 6.3 x 25mm | FX0415/S - 6.3 x 32mm FX0416/S - 6.3 x 25mm |
| Fuse Carrier: | Screw cap/Screwdriver release | Screw cap/Screwdriver release |
| Terminations: | 4.8 series tabs | 4.8 series tabs |
| Max. Rating: | 13A, 250V (16A, 250V UL) | 13A, 250V (16A, 250V UL) |
| Max. Power Dissipation: | 4W (@ 23°C) | 4W (@ 23°C) |
| Insulation Resistance: | >10 ⁵ MΩ @ 500V DC | >10 ⁵ MΩ @ 500V DC |
| A.C. Breakdown: | 4kV @ 50Hz | 4kV @ 50Hz |
| Contact Resistance: | <5mΩ | <5mΩ |
| Operating Temp: | -20°C to +85°C (ambient air temp + fuse temp rise) | -20°C to +85°C (ambient air temp + fuse temp rise) |
| Mouldings: | | |
| Body: | Glass Filled Nylon UL94V-0 rated | Glass Filled Nylon UL94V-0 rated |
| Cap: | Nylon UL94V-0 rated | Nylon UL94V-0 rated |
| Nut: | Polyester UL94V-0 rated | Polyester UL94V-0 rated |
| Contacts: | Brass, Silver Plated | Brass, Silver Plated |
| Approvals: |  |  |
| Accessories: | P.No. 12932 (See page 17) | P.No. 12932 (See page 17) |
|  | Compliant | Compliant |

Panel Mount



FX0354

- Protection Category PC2
- Low Profile Bezel
- Fuse Size 5 x 20mm
- Screw Cap/Screwdriver Release
- Keyway Panel Cutout
- 6.3A, 250V

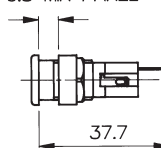
6.4 MAX Panel
0.8 MIN PANEL

Fixing Details

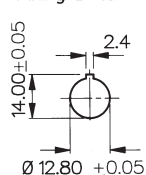

Panel Mount



FX0354/S

- Protection Category PC2
- High Profile Bezel
- Fuse Size 5 x 20mm
- Screw Cap/Screwdriver Release
- Keyway Panel Cutout
- 6.3A, 250V

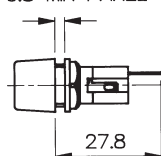
2.4 MAX Panel
0.8 MIN PANEL

Fixing Details

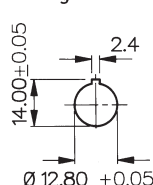

| Specifications | FX0354 | FX0354/S |
|-------------------------|---|---|
| Fuse Size: | 5 x 20mm | 5 x 20mm |
| Fuse Carrier: | Screw cap/Screwdriver release | Screw cap/Screwdriver release |
| Terminations: | Solder tags | Solder tags |
| Max. Rating: | 6.3A, 250V | 6.3A, 250V |
| Max. Power Dissipation: | 2.5W (@ 23°C) | 2.5W (@ 23°C) |
| Insulation Resistance: | >10 ² MΩ @ 500V DC | >10 ² MΩ @ 500V DC |
| AC Breakdown: | 5kV @ 50Hz | 5kV @ 50Hz |
| Contact Resistance: | <10mΩ | <10mΩ |
| Operating Temp: | -20°C to +85°C (ambient air temp + fuse temp rise) | -20°C to +85°C (ambient air temp + fuse temp rise) |
| Mouldings: | | |
| Body: | Polyester UL94V-0 rated | Polyester UL94V-0 rated |
| Cap: | Nylon UL94V-0 rated | Nylon UL94V-0 rated |
| Nut: | Glass Filled Nylon UL94V-0 rated | Glass Filled Nylon UL94V-0 rated |
| Contacts: | Brass, Silver Plated | Brass, Silver Plated |
| Approvals: | | |
| Accessories: | P.No. 11327 and 12298 (See page 17) | P.No. 11327 and 12298 (See page 17) |
| RoHS | Compliant | Compliant |



Key Features

- 6.3 x 32mm fuses
- Screwdriver slot knob
- PC2 protection category
- 4.8, 6.3 and solder terminals
- Low profile bezel
- Snap in or threaded bushing mounting options

Approvals and specifications

 16A UL 250V UL file E92075 CSA file LR44770

These products comply with safety category PC2. Users should be aware of the de-rating factors published by specialist manufacturers of fuses.

Fuseholders with Inline termination have combination (4.8/6.3) terminals. It has not been possible to show both views here. Units with right angle terminals have user specified end terminals and combination mid-body terminals.

| | | | | | | |
|----------|---|-------------|---|------------|---|-------------|
| T | / | 0347 | / | RA | / | ---- |
| Terminal | | Body & Cap | | Panel Hole | | Options |

Terminal

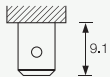
C

6.3 x 0.8

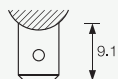
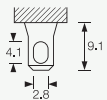
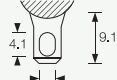
D6.3 x 0.8
Right Angle**T**4.8 x 0.8
Solder**U**4.8 x 0.8
Right Angle

Body

0345 (C terminal shown)
Screwdriver release**0345** (D terminal shown)
Screwdriver release**0347** (T terminal shown)
Screwdriver release**0347** (U terminal shown)
Screwdriver release

Options

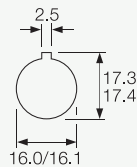
RA

Panel thickness
0.8 - 2.0mm for snap fit
0.8 - 7.0mm for screw to
panel fixing

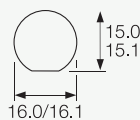
RD

Panel thickness
0.8 - 2.0mm for snap fit
0.8 - 7.0mm for screw to
panel fixing

Dimensions

0345 (C terminal shown)

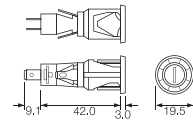

0345 (D terminal shown)

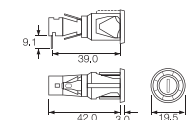

0347 (C terminal shown)

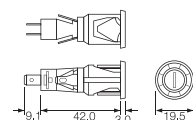

0347 (D terminal shown)

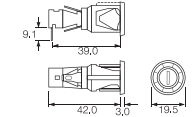

Optional metal fixing nut available for 0347

Panel Mount



FX0296/S

FX0296

- ⬡ Protection Category PC1
- ⬡ Fuse Size 5 x 20mm
- ⬡ Screw Cap/Hand Release
- ⬡ 6.3A, 250V

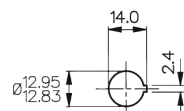

Fixing Details

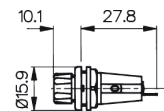

 3.2 MAX Panel
 1.0 MIN Panel

Panel Mount

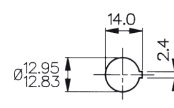

FX0296/1

- ⬡ Protection Category PC1
- ⬡ Fuse Size 5 x 20mm
- ⬡ Screw Cap/Hand Release
- ⬡ 6.3A, 250V

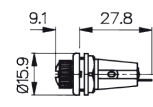

Fixing Details

 3.2 MAX Panel
 1.0 MIN Panel

| Specifications | FX0296, FX0296/S | FX0296/1 |
|-------------------------|---|---|
| Fuse Size: | 5 x 20mm | 5 x 20mm |
| Fuse Carrier: | FX0296 Screw cap/Hand release FX0296/S Screw cap/Screwdriver release | Screw cap/Hand release |
| Terminations: | Solder tags | Solder tags |
| Max. Rating: | 6.3A, 250V | 6.3A, 250V |
| Max. Power Dissipation: | 2.5W (@ 23°C) | 2.5W (@ 23°C) |
| Insulation Resistance: | >10 ⁵ MΩ @ 500V DC | >10 ⁵ MΩ @ 500V DC |
| AC Breakdown: | 2.5kV @ 50Hz | 2.5kV @ 50Hz |
| Contact Resistance: | <5mΩ | <5mΩ |
| Operating Temp: | -20°C to +85°C (ambient air temp + fuse temp rise) | -20°C to +85°C (ambient air temp + fuse temp rise) |
| Mouldings: | | |
| Body: | Glass Filled Nylon UL94V-0 rated Nylon | Glass Filled Nylon UL94V-0 rated Nylon |
| Cap: | UL94V-0 rated | UL94V-0 rated |
| Nut: | Glass Filled Nylon UL94V-0 rated | Glass Filled Nylon UL94V-0 rated |
| Contacts: | Brass, Silver or Tin Plated | Brass, Silver or Tin Plated |
| Accessories | P.No. 9820 (See page 17) | P.No. 9820 (See page 17) |
| RoHS | Compliant | Compliant |

Panel Mount



FX0419

- Panel sealed to IP68
- Touchproof Category PC2
- Fuse Size 6.3 x 32mm
- Screw cap/Screwdriver/Hand Release
- 16A. 250V AC

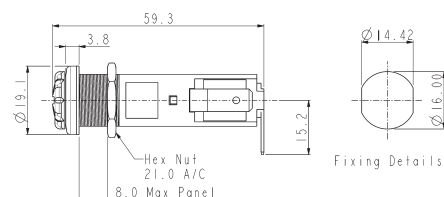

Panel Mount



FX0462

- Panel sealed to IP68
- Touchproof Category PC2
- Fuse Size 5 x 20mm
- Screw cap/Screwdriver/Hand Release
- 10A. 250V AC

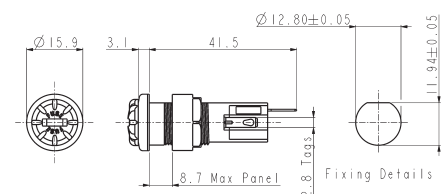







Panel Mount

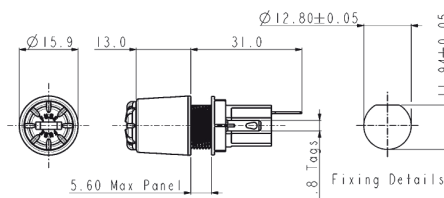

FX0463

- Panel sealed to IP68
- Touchproof Category PC2
- Fuse Size 5 x 20mm
- High Profile Bezel
- Screw cap/Screwdriver/Hand Release
- 10A. 250V AC



| Specifications | FX0419 | FX0462 | FX0463 |
|-------------------------|--|---|---|
| Fuse Size: | 6.3 x 32mm | 5.0 x 20mm | 5.0 x 20mm |
| Fuse Carrier: | Screw cap/Screwdriver/Hand release | Screw cap/Screwdriver/Hand release | Screw cap/Screwdriver/Hand release |
| Terminations: | 6.3 series tabs | Solder tags | Solder tags |
| Max. Rating: | 16A, 250V AC | 10A, 250V AC | 10A, 250V AC |
| Max. Power Dissipation: | 2.5W (@ 23°C) | 2.5W (@ 23°C) | 2.5W (@ 23°C) |
| Insulation Resistance: | >10 ⁸ MΩ @ 500V DC | >10 ⁸ MΩ @ 500V DC | >10 ⁸ MΩ @ 500V DC |
| A.C. Breakdown: | >2kV @ 50Hz | >7kV @ 50Hz | >7kV @ 50Hz |
| Contact Resistance: | <10mΩ | <10mΩ | <10mΩ |
| Operating Temp: | -20°C to +85°C (ambient air temp + fuse temp rise) | -20°C to +85°C (ambient air temp + fuse temp rise) | -20°C to +85°C (ambient air temp + fuse temp rise) |
| Mouldings: | | | |
| Body: | Polyester UL94V-0 rated | Polyester UL94V-0 rated | Polyester UL94V-0 rated |
| Cap: | Nylon UL94V-0 rated | Nylon UL94V-0 rated | Nylon UL94V-0 rated |
| Nut: | Glass Filled Nylon UL94V-0 rated | Glass Filled Nylon UL94V-0 rated | Glass Filled Nylon UL94V-0 rated |
| Contacts: | Brass, Silver Plated | Brass, Silver Plated | Brass, Silver Plated |
| Tightening Torque: | | | |
| Cap: | 0.5 - 0.6Nm (4.43-5.3lbf.in.) | 0.4 - 0.6Nm (3.54-5.3lbf.in.) | 0.4 - 0.6Nm (3.54-5.3lbf.in.) |
| Panel Nut: | 0.5Nm (4.4lbf.in.) | 0.5Nm (4.4lbf.in.) | 0.5Nm (4.4lbf.in.) |
| Sealing: | IP68 to EN60529:1992+A2:2013 (10m for 2weeks) | IP68 to EN60529:1992+A2:2013 (10m for 2weeks) | IP68 to EN60529:1992+A2:2013 (10m for 2weeks) |
| Accessories: | | P.nos. 11327 (See page 17) | P.nos. 11327 (See page 17) |
| Approvals: |  *VDE APPROVALS PENDING |   |   |
| RoHS | Compliant | Compliant | Compliant |

High Profile Panel Mount



FX0345

- ⬡ Sealed to IP66
- ⬡ Protection Category PC1
- ⬡ Fuse Size 5 x 20mm
- ⬡ Screw Cap/Screwdriver Release
- ⬡ 6.3A, 250V

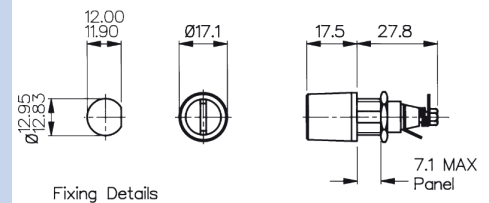

High Profile Panel Mount



FX0365

- ⬡ Sealed to IP66
- ⬡ Protection Category PC1
- ⬡ Fuse Size 5 x 20mm
- ⬡ Screw Cap/Hand Release
- ⬡ Large Cap for Easy Grip
- ⬡ 6.3A, 250V

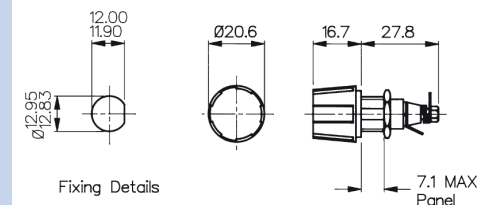

| Specifications | FX0345, FX0345/A | FX0365, FX0365/A |
|-------------------------|---|--|
| Fuse Size: | 5 x 20mm | 5 x 20mm |
| Fuse Carrier: | Screw cap/Screwdriver release | Screw cap/Screwdriver release |
| Terminations: | Solder tags | Solder tags |
| Max. Rating: | 6.3A, 250V | 6.3A, 250V |
| Max. Power Dissipation: | 4W (@ 23°C) | 4W (@ 23°C) |
| Insulation Resistance: | >10 ³ MΩ @ 500V DC | >10 ³ MΩ @ 500V DC |
| AC Breakdown: | >3.5kV @ 50Hz | >3.5kV @ 50Hz |
| Contact Resistance: | <10mΩ | <10mΩ |
| Operating Temp: | -20°C to +85°C (ambient air temp + fuse temp rise) | -20°C to +85°C (ambient air temp + fuse temp rise) |
| Mouldings: | | |
| Body & Cap: | Glass Filled Nylon UL94V-0 rated | Glass Filled Nylon UL94V-0 rated |
| Spacer: | Glass Filled Nylon UL94HB rated | Glass Filled Nylon UL94HB rated |
| Insulating Sleeve: | Nylon UL94V-0 rated | Nylon UL94V-0 rated |
| Contacts: | Brass, Silver Plated | Brass, Silver Plated |
| Sealing: | Protection Classification IP66 to EN60529:1992+A2:2013 Retains sealing integrity with cap removed since they are both panel and barrier sealed | |
| Variants: | /A Silicone 'O' ring, Op. Temp. -55°C to +85°C Compliant | /A Silicone 'O' ring, Op. Temp. -55°C to +85°C Compliant |

RoHS

PCB Horizontal Mount



FX0461

- Protection Category PC3
- Fuse Size 5 x 20mm
- Screw Cap/Screwdriver Release
- Captive Fuse Carrier
- PC Spills
- 10A, 250V
- (16A, 250V UL)

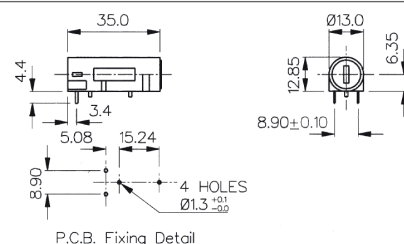

PCB Horizontal and Vertical Mount



FX0457

FX0456

- Protection Category PC2
- Fuse Sizes 5 x 20mm
- Bayonet Cap/Screwdriver Release
- 10A, 250V

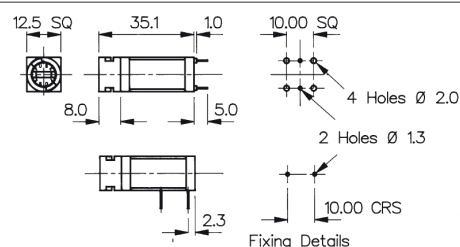

PCB Horizontal Mount





FX0330

FX0342

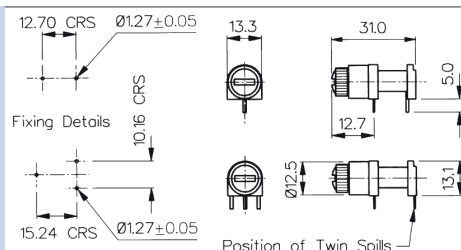
- Protection Category PC1
- Fuse Size 5 x 20mm
- Two or Three PC Spills
- Screw Cap/Hand Release
- 6.3A, 250V



| Specifications | FX0461 | FX0456 FX0457 | FX0330 FX0342 |
|-------------------------|---|---|---|
| Fuse Size: | 5 x 20mm | 5 x 20mm | 5 x 20mm |
| Fuse Carrier: | Screw cap/Screwdriver release | Bayonet cap/Screwdriver release | Screw cap/Hand release |
| Terminations: | PC Spills | PC Spills | FX0330 - 3 PC Spills FX0342 - 2 PC Spills |
| Max. Rating: | 10A, 250V (16A, 250V AC UL) | 10A, 250V | 6.3A, 250V |
| Max. Power Dissipation: | 1.6W (@ 23°C) | 2.5W (@ 23°C) | 2.5W (@ 23°C) |
| Insulation Resistance: | >10MΩ @ 500V DC | >10 ⁴ MΩ @ 500V DC | >10 ⁴ MΩ @ 500V DC |
| AC Breakdown: | >2kV | 4kV @ 50Hz | 6kV @ 50Hz |
| Contact Resistance: | <10mΩ | <10mΩ | <5mΩ |
| Operating Temp: | -20°C to +85°C (ambient air temp + fuse temp rise) | -20°C to +85°C (ambient air temp + fuse temp rise) | -20°C to +85°C (ambient air temp + fuse temp rise) |
| Mouldings: | | | |
| Body: | Polyester UL94V-0 rated | Polyester UL94V-0 rated | Glass Filled Nylon UL94V-0 rated |
| Cap: | Nylon UL94V-0 rated | Nylon UL94V-0 rated | Nylon UL94V-0 rated |
| End Bung: | | Polyester UL94V-0 rated | |
| Contacts: | Brass, Silver Plated | Brass, Silver Plated | Brass, Tin Plated |
| Approvals: |  |  | |
| RoHS | Compliant | Compliant | Compliant |

PCB Mount

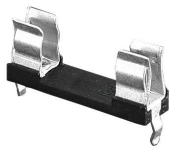

FX0321

- Protection Category PC1
- Fuse Size 5 x 20mm
- PC Spills
- 6.3A, 250V

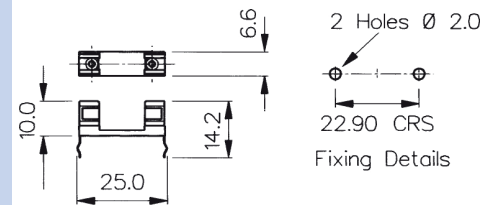

Base Mount



FX0267

- Protection Category PC1
- Fuse Size 5 x 20mm
- Solder Tags
- 6.3A, 250V

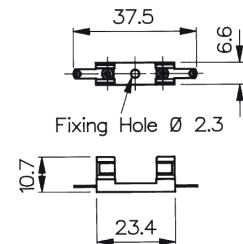

Base Mount



FX0360

- Protection Category PC1
- Fuse Size 5 x 20mm
- Solder Tags
- 6.3A, 250V

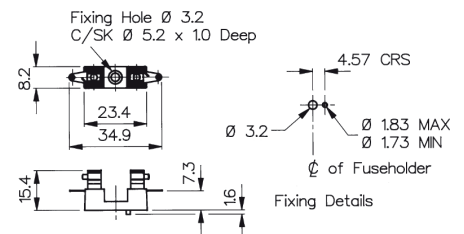

| Specifications | FX0321 | FX0267 | FX0360 |
|---|----------------------------------|----------------------------------|---------------------------------|
| Fuse Size: | 5 x 20mm | 5 x 20mm | 5 x 20mm |
| Terminations: | PC Spills | Solder tags | Solder tags |
| Max. Rating: | 6.3A, 250V | 6.3A, 250V | 6.3A, 250V |
| Insulation Resistance: | >10 ⁵ MΩ @ 500V DC | >10 ⁵ MΩ @ 500V DC | >10 ⁴ MΩ @ 500V DC |
| AC Breakdown: | 7kV @ 50Hz (Clip to clip) | 1.5kV @ 50Hz | 2kV @ 50Hz |
| Contact Resistance: | <10mΩ | <10mΩ | <10mΩ |
| Operating Temp: (ambient air temp + fuse temp rise) | -20°C to +85°C | -20°C to +85°C | -20°C to +85°C |
| Base Material: | Glass Filled Nylon UL94V-0 rated | Glass Filled Nylon UL94V-0 rated | Glass Filled Nylon UL94HB rated |
| Contacts: | Phosphor Bronze, Tin Plated | Phosphor Bronze, Tin Plated | Phosphor Bronze, Tin Plated |
| Accessories: | P.No. 12760 (See page 17) | P.No. 12760 (See page 17) | |
| RoHS | Compliant | Compliant | Compliant |

Base Mount



FX0326 FX0331

- Protection Category PC1
- Fuse Sizes:
 - 6.3 x 32mm (FX0326)
 - 6.3 x 25mm (FX0331)
- Solder Tags
- 13A, 250V



Fixing Details

| List No. | DIM A | DIM B |
|----------|-------|-------|
| FX0326 | 56.0 | 37.5 |
| FX0331 | 50.0 | 31.0 |

Base Mount



FX0327



- Protection Category PC1
- Fuse Size 6.3 x 32mm
- Solder Tags
- 5A, 250V



Fixing Detail

| Specifications | FX0326, FX0331 | FX0327 |
|---|---|--------------------------------------|
| Fuse Size: | FX0326 - 6.3 x 32mm FX0331 - 6.3 x 25mm | 6.3 x 32mm |
| Terminations: | 6.3 series tabs | Solder tags |
| Max. Rating: | 13A, 250V | 5A, 250V |
| Insulation Resistance: | >10 ⁴ MΩ @ 500V DC | >10 ⁵ MΩ @ 500V DC |
| A.C. Breakdown: | 5kV @ 50Hz | 5kV @ 50Hz |
| Contact Resistance: | <5mΩ | <10mΩ |
| Operating Temp: (ambient air temp + fuse temp rise) | -20°C to +85°C | -20°C to +85°C |
| Base Material: | Glass Filled Polyester UL94V-0 rated | Glass Filled Polyester UL94V-0 rated |
| Contacts: | Clips: Phosphor Bronze, Tin Plated Tabs: Brass, Tin Plated | Phosphor Bronze, Tin Plated |
| RoHS | Compliant | Compliant |

| <p>Inline</p>  <p>FX0180, FX0280, FX0380</p> | <ul style="list-style-type: none">○ Protection Category PC1○ Fuse Sizes 5 x 20mm, 6.3 x 25mm and 6.3 x 32mm○ Screw Terminal (Solder to order)○ 10A, 50V (250V Inaccessible)○ UL Approved (Black Only)○ Clear or black |  <table><tr><th>List No.</th><th>DIM A</th></tr><tr><td>FX0180</td><td>60.3</td></tr><tr><td>FX0280</td><td>54.5</td></tr><tr><td>FX0380</td><td>48.6</td></tr></table> | List No. | DIM A | FX0180 | 60.3 | FX0280 | 54.5 | FX0380 | 48.6 |
|---|---|--|----------|-------|--------|------|--------|------|--------|-------------|
| List No. | DIM A | | | | | | | | | |
| FX0180 | 60.3 | | | | | | | | | |
| FX0280 | 54.5 | | | | | | | | | |
| FX0380 | 48.6 | | | | | | | | | |
| <p>Inline</p>  <p>FX0185, FX0285, FX0385</p> | <ul style="list-style-type: none">○ Sealed to IP66○ Protection Category PC1○ Fuse Sizes 5 x 20mm, 6.3 x 25mm and 6.3 x 32mm○ Screw Terminal (Solder to order)○ 10A, 50V (250V Inaccessible)○ UL Approved (Black Only)○ Clear or black |  <table><tr><th>List No</th><th>DIM A</th></tr><tr><td>FX0185</td><td>91.0</td></tr><tr><td>FX0285</td><td>85.2</td></tr><tr><td>FX0385</td><td>78.7 +/-0.9</td></tr></table> | List No | DIM A | FX0185 | 91.0 | FX0285 | 85.2 | FX0385 | 78.7 +/-0.9 |
| List No | DIM A | | | | | | | | | |
| FX0185 | 91.0 | | | | | | | | | |
| FX0285 | 85.2 | | | | | | | | | |
| FX0385 | 78.7 +/-0.9 | | | | | | | | | |

| Specifications | FX0180/Colour, FX0280/Colour, FX0380/Colour | FX0185/Colour, FX0285/colour, FX0385/Colour |
|--|--|---|
| Fuse Size: | 5 x 20mm FX0380 6.3 x 25mm FX0280 6.3 x 32mm FX0180 | 5 x 20mm FX0385 6.3 x 25mm FX0285 6.3 x 32mm FX0185 |
| Cable Acceptance: | 1mm ² conductor (max.) | 1mm ² conductor (max.) 1mm to 2.64mm overall diameter Stepped grommet: Stage 1: 1.00mm to 1.40mm Stage 2: 1.50mm to 1.90mm Stage 3: 2.0mm to 2.64mm |
| Terminations: | Screw terminal (solder to order) | Screw Terminal (solder to order) |
| Max. Rating: | 10A, 50V (250V where inaccessible inside equipment) | 10A, 50V (250V where inaccessible inside equipment) |
| Insulation Resistance: | >10 ⁵ MΩ @ 500V DC | >10 ⁵ MΩ @ 500V DC |
| High Voltage Proof Test: | 2kV (50Hz for 1 minute) | 2kV (50Hz for 1 minute) |
| Contact Resistance: | <10mΩ | <10mΩ |
| Operating Temp: (ambient air temp + fuse temp rise) | -20°C to +90°C | -20°C to +70°C |
| Sealing: | | Protection Classification IP66 EN60529: 1992+A2:2013 |
| Screw Tightening Torque | 0.226Nm (2lb/in) | 0.226Nm (2lb/in) |
| Mouldings: | | Polybutene UL94HB rated Nylon 6 UL94V-0 rated PVC Nitrile |
| Body - Clear: | Polybutene UL94HB rated | |
| Body - Black: | Nylon 6 UL94V-0 rated | |
| Grommet: | | |
| O Ring: | | |
| Contacts: | | |
| Terminals: | Brass, Nickel Plated | Brass, Nickel Plated |
| Grub Screw: | Stainless Steel | Stainless Steel |
| Approvals: |  (Black version only) |  (Black version only) |
| Colour: | Clear - no suffix, /BK - Black | Clear - no suffix, /BK - Black |
| RoHS | Compliant | Compliant |

Insulation Boots



PNo. 11327 PNo. 12932 PNo. 9820

- Provide Insulation against Shock on Rear of Fuseholder
- PVC
- UL94V-0 rated flame retardant material

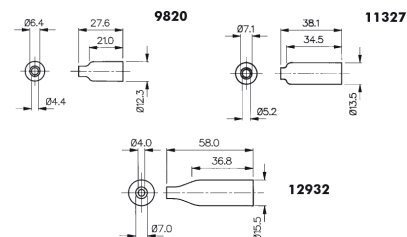

Insulation Cover

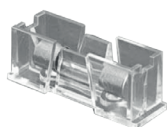

PNo. 12760

- Provide Insulation from Live Parts on Fuseholder
- Clear
- Polycarbonate

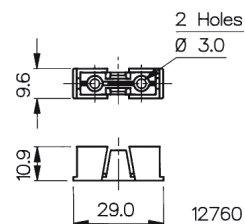

Adaptor



PNo. 12297

- Adaptor to Convert Fixing Holes
- Maintains Anti-Rotation
- Glass Filled Nylon

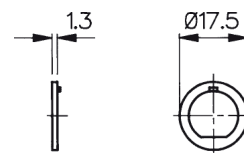

12297

Accessories

For Use With:

| | |
|------------------------------|--|
| P.No. 9820 (Boot) | FX0296, FX0296/1, FX0296/S |
| P.No. 11327 (Boot) | FX0354, FX0354/S, FX0357, FX0359, FX0454, FX0454/S, FX0455, FX0455/S, FX0458, FX0367, FX0369, FX0462, FX0463 |
| P.No. 12932 (Boot) | FX0415, FX0415/S, FX0416, FX0416/S |
| P.No. 12760 (Cover) | FX0267, FX0321 |
| Max. Working Voltage: | 250V AC |
| Flash Tested to: | 2kV AC |
| Material: | P.Nos. 9820, 11327, 12932: PVC - UL94V-0 P.No. 12760: Polycarbonate |
| P.No. 12297 (Adaptor Washer) | Adapts 'D' fixing to anti-rotation Key Fixing FX0455, FX0455/S |
| Material: | Glass Filled Nylon |
| RoHS | Compliant |